

Unit: mm

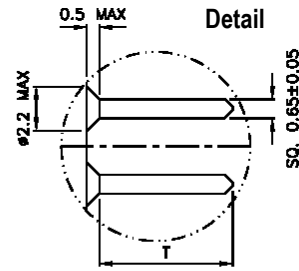

PCB Layout

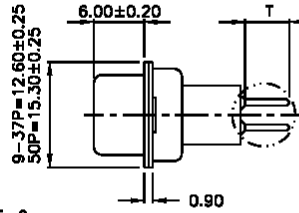
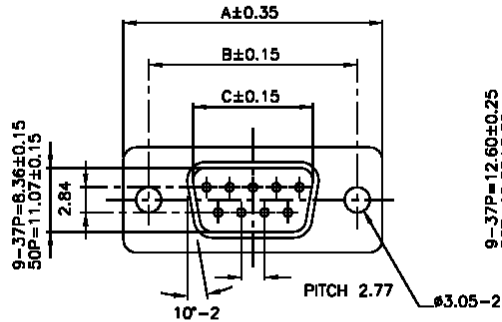
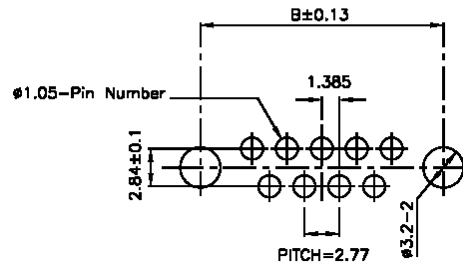
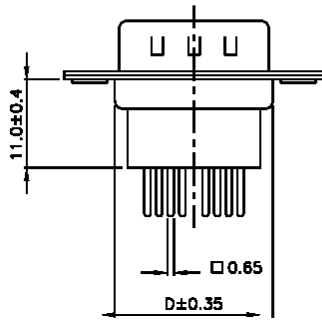

SPECIFICATIONS

Current rating:	5 amps
Contact material:	Brass, stamped pin
Contact plating:	Gold in contact area Gold or tin on solder tails
Contact resistance:	15 milliohms max.
Insulator material:	PBT and Nylon 6T, UL94V-0
Insulator resistance:	1,000 megohms min.
Shell material:	Steel
Shell plating:	Tin
Withstanding:	500VAC for 1 min.
Operating temperature:	-50°C to +100°C

Dimensions (mm)					
Pos.	A	B	C	D	T
9	30.80	24.99	16.92	19.20	3.0 4.3 4.8 6.5
15	39.15	33.32	25.25	27.70	
25	53.00	47.04	38.96	41.10	
37	69.30	63.50	55.42	57.30	
50	67.00	61.00	52.80	55.10	

Series	Type	Tail Options	Face Options	Other Options
DSXX	MHT	X	XXX	XX
D-sub connector XX=Pins 9, 15, 25, 37, 50	FT=Female vertical mount MT=Male vertical mount MHT=Male high profile FHT=Female high profile	A1=3.0mm A2=4.3mm A3=4.8mm A4=6.5mm B=Wire wrap	[blank]=.120" thru hole RCN=Clinch nut RJS=Jackscrew RSB=Standoff with board locks	[blank]=None FF=Ferrite filter YC=Yellow chromate shell

RoHS compliant

Rev.	Description	Date	Approved	Drawing	Name	Date
				Approved	Howard	08/10/99
				Checked	Lizzy	08/10/99
				Drawn	Tina	08/10/99
				0.0 ± 0.35	0.00 ± 0.20	Angles ± 3'
				UNIT: mm		

Central Components Manufacturing
 440 Lincoln Blvd., Middlesex, New Jersey 08846
 Phone 732 469-5720 888 288-5152 Fax 732 469-1919

Part No.: **DSXX-MHT-X-XXX-XX**

Description: D-subminiature connector, male, high profile, vertical PCB mount, stamped pin