

Standard Mount Unshielded

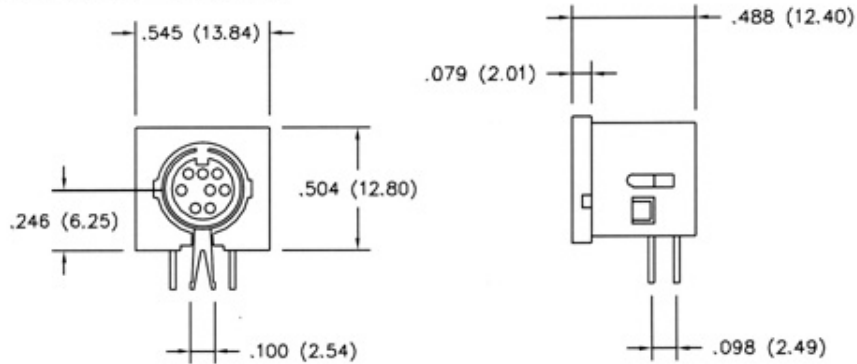

Standard Mount Four Sided Shield

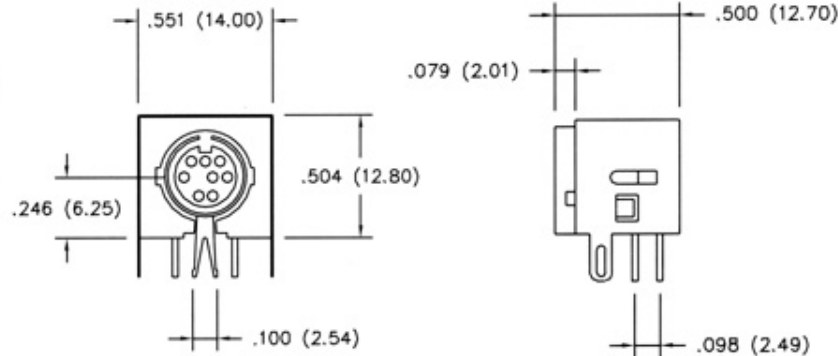

SPECIFICATIONS

Operating Voltage:	30 VAC Max.
Current Rating:	2 amps max.
Contact Resistance:	20 milliohms max.
Insulation Resistance:	500 megohms min.
Withstanding:	500VAC for 1 min.
Shield:	Steel, nickel plated
Inner Shield:	Iron sheet, nickel plated
Insulator:	PBT Glass Reinforced UL94V-0
Contacts:	Phosphor bronze
Contact Plating:	Gold over Nickel
Cycle Life:	5000 insertion/separation cycles
Operating Temp:	-25C to +105C

Series	Size	Housing	Options
CMDJ	XX	XX	XX
Circular Mini DIN Jack, Right Angle	3-9 positions	A=Non Shielded B=Metal Shrouded C=Five Side Metal Shield	GDXX=Gold Plating XX=flash if blank, 5,10,15,20,30 u" KT=Side Kinked Snap (not shown)

Rev.	Description	Date	Approved	Drawing	Name	Date
				Approved	Howard	08/30/05
				Checked	Lizzy	08/30/05
				Drawn	Tina	08/30/05
				0.0 ± 0.35	0.00 ± 0.20	Angles ± 3'
				UNIT: mm		



Central Components Manufacturing

440 Lincoln Blvd., Middlesex, New Jersey 08846
Phone 732 469-5720 888 288-5152 Fax 732 469-1919

Part No.: **CMDJ-XX-X-XX**

Description: Mini Connectors: Circular Mini DIN Jacks

Standard Mount Five Sided Shield

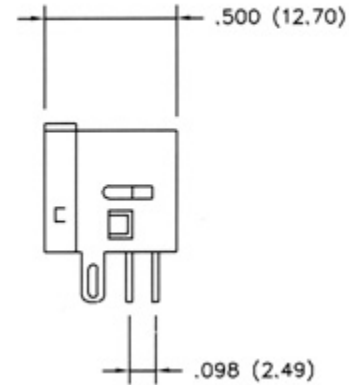
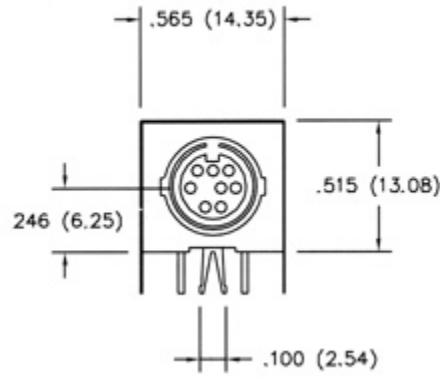

Face Plate Configurations

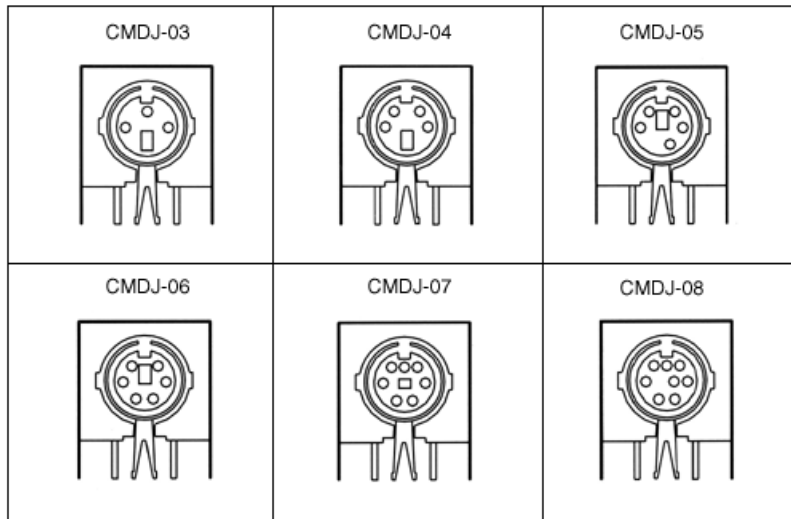

PC Board Layouts

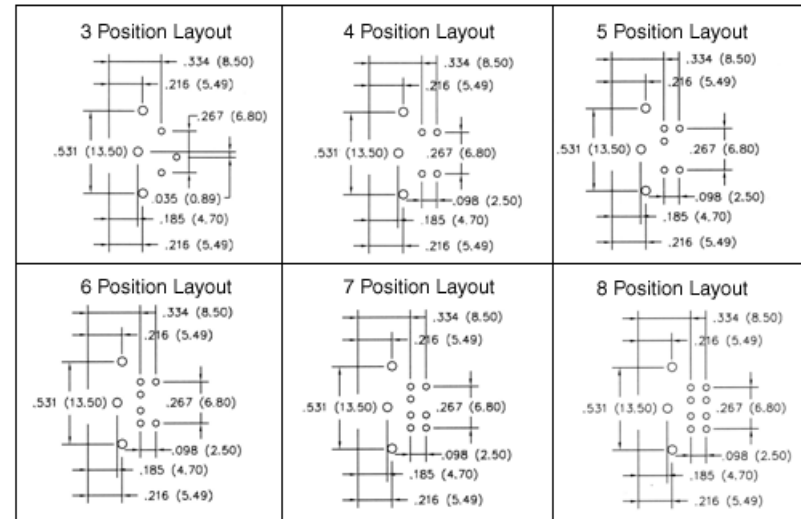

Rev.	Description	Date	Approved	Drawing	Name	Date
				Approved	Howard	08/30/05
				Checked	Lizzy	08/30/05
				Drawn	Tina	08/30/05
				0.0 ± 0.35	0.00 ± 0.20	Angles ± 3'
					UNIT: mm	

Central Components Manufacturing
440 Lincoln Blvd., Middlesex, New Jersey 08846
Phone 732 469-5720 888 288-5152 Fax 732 469-1919

Part No.: **CMDJ-XX-X-XX**

Description: Mini Connectors: Circular Mini DIN Jacks