

**SPECIFICATIONS**  
 Terminal material: Brass  
 Terminal thickness: 0.2mm  
 Terminal plating: Tin plated 60μ", gold 30μ"  
 Wire range: AWG #22-28  
 Insulation O.D.: 1.7mm max.

Note: It is recommended that this terminal be used in a housing having few poles.

A-A SECTION

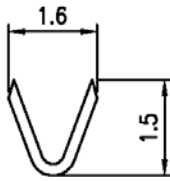
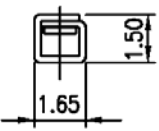
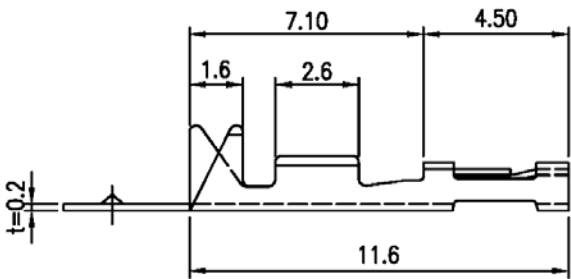

B-B SECTION

Series	Size	Package
CHC	A	XX
2.54mm crimp terminal	A = 22-28 AWG	RL=Reel, 10K pcs per BG=Loose bag 1K pcs per

RoHS compliant

Rev.	Description	Date	Approved	Drawing	Name	Date
				Approved	Howard	08/10/99
				Checked	Lizzy	08/10/99
				Drawn	Tina	08/10/99
				0.0 ± 0.35	0.00 ± 0.20	Angles ± 3'
				UNIT: mm		

**Central Components Manufacturing**  
 440 Lincoln Blvd., Middlesex, New Jersey 08846  
 Phone 732 469-5720 888 288-5152 Fax 732 469-1919

Part No.: **CHC-A-XX**

Description: 2.54mm (.100") crimp terminal