

SPECIFICATIONS

Current rating: 1 amp
 Contact material: Phosphor bronze
 Contact plating: Tin, selective gold, gold flash, gold plate
 Insulator material: PBT, glass reinforced UL94V-0
 Withstanding: 250VAC 1 min.
 Contact resistance: 30 milliohms max.
 Insulation resistance: 1000 megohms min.
 Operating temperature: -40°C to +105°C
 Terminates with: 0.635mm pitch flat ribbon cable

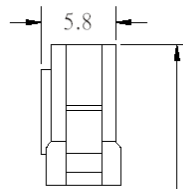
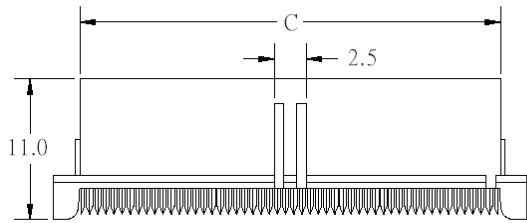

(12.4) TERMINATED HEIGHT

Restricted part only available on cables.

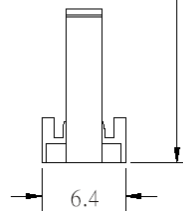
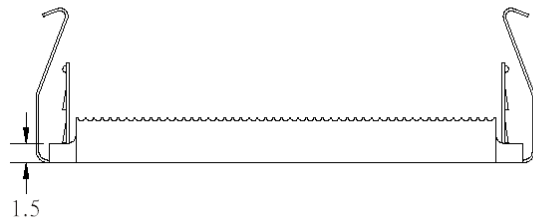

Dimensions			
Pos.	A	B	C
10	11.43	5.08	7.43
14	13.97	7.62	9.97
16	15.24	8.89	11.24
20	17.78	11.43	13.78
24	20.32	13.97	16.32
26	21.59	15.24	17.59
30	24.13	17.78	20.13
34	26.67	20.32	22.67
40	30.48	24.13	26.48
44	33.02	26.67	29.02
50	36.83	30.48	32.83
60	43.18	36.83	39.18
64	45.72	39.37	41.72
68	48.26	41.91	44.26
72	50.80	44.45	46.80
80	55.88	49.53	51.88
100	68.58	62.23	64.58

Series	No. of Contacts	Polarity	Contact Plating
CFCA-HD	XX	XX	XX
High density IDC socket	10, 14, 16, 20, 24, 26, 30, 34, 40, 44, 50, 60, 64, 68, 72, 80, 100	N=With polarity NP=No polarity	TN=Tin plate; SG=Selective gold; GD=Gold flash; GD05=5μ" gold; GD10=10μ" gold; GD15=15μ" gold; GD30=30μ" gold

RoHS compliant

Rev.	Description	Date	Approved	Drawing	Name	Date
				Approved	Howard	8/10/99
				Checked	Lizzy	8/10/99
				Drawn	Tina	8/10/99
				0.0 ± 0.35	0.00 ± 0.20	Angles ± 3'
				UNIT: mm		

Central Components Manufacturing
 440 Lincoln Blvd., Middlesex, New Jersey 08846
 Phone 732 469-5720 888 288-5152 Fax 732 469-1919

Part No.: **CFCA-HD-XX-XX-XX**

Description: 1.27mm pitch high density IDC socket