

SPECIFICATIONS

Voltage rating: 250VAC
 Current rating: 1 amp
 Contact material: Copper alloy
 Contact resistance: 30 milliohms max.
 Contact plating: Gold over nickel in contact area
 Tin over nickel on solder tails

Insulator material: Thermoplastic Nylon 9T +GF, UL94V-0
 Insulation resistance: 1,000 megohms min.
 Withstanding: 500VAC for 1 min.
 Insertion force: 230g per contact pair max.
 Withdrawal force: 15g per contact pair min.
 Retention force: 460g per contact min.
 Operating temperature: -55°C to +85°C
 Processing temperature: 260°C/10sec.

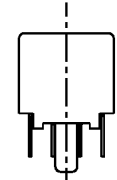
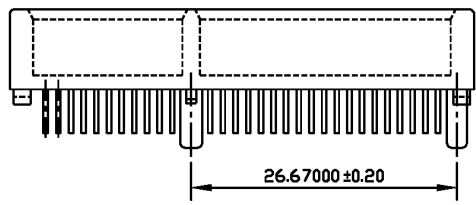
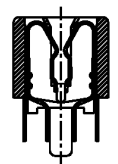

Dimensions						
Pins	A	B	C	D	E	F
60	25.85	15.88	22.86	12.70	46.61	26.67
68	31.12	15.88	27.94	12.70	51.88	31.75

SECTION A-A

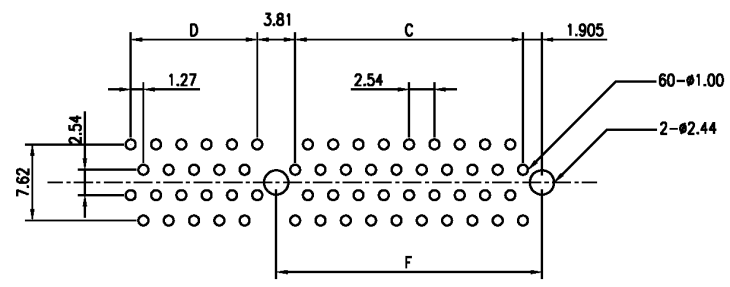

Recommended PC Board Layout (Top View)

RoHS compliant

Series	Type	Positions	Plating
CCE-PCI	060509	XX	SG
PCI card edge connector	Low profile, post type	60=60 positions 68=68 positions	SG=Selective gold

Rev.	Description	Date	Approved	Drawing	Name	Date
				Approved	Howard	05/05/06
				Checked	Lizzy	05/05/06
				Drawn	Tina	05/05/06
				0.0 ± 0.35	0.00 ± 0.20	Angles ± 3'
				UNIT: mm		

Central Components Manufacturing
 440 Lincoln Blvd., Middlesex, New Jersey 08846
 Phone 732 469-5720 888 288-5152 Fax 732 469-1919

Part No.: **CCE-PCI-060509-XX-SG**
 Description: PCI card edge connector, low profile, post type, 60 or 68 pins