

**Recommended  
P.C. Board Hole Layout**

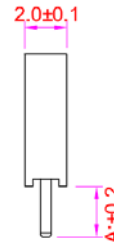

**SPECIFICATIONS**

Current Rating:	2 Amps
Insulator Resistance:	1000 Megohms min.
Contact Resistance:	20m ohms max.
Withstanding:	AC 500V
Contact Material:	Brass
Insulator Material:	Polyester, UL94V-0, Nylon 9T
Operating Temp:	-40C to +105C

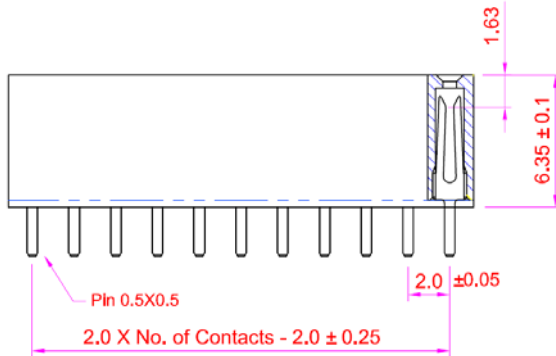

Series	Rows	Profile	Contacts	Tail length(mm)	Plating	Options
BRS	0X	HP	XX	X	XX	XX
2mm Receptacle strip	01=Single 02=Dual	HP=6.35mm	Single row 01-40 Dual row 02-80	A=2.4 (std) B=3.0 C=5.3	TN=Tin SGXX=Selective Gold GDXX=Gold XX=flash if blank, 15, 30, 50u"	[blank]=None SM=Surface mount

**RoHS compliant**

Rev.	Description	Date	Approved	Drawing	Name	Date
				Approved	Howard	11/26/09
				Checked	Lizzy	11/26/09
				Drawn	Tina	11/26/09
				0.0 ± 0.35	0.00 ± 0.20	Angles ± 3'
					UNIT: mm	

**Central Components Manufacturing**  
 440 Lincoln Blvd., Middlesex, New Jersey 08846  
 Phone 732 469-5720 888 288-5152 Fax 732 469-1919

Part No.: **BRS-01-HP-XX-X-XX-XX**

Description: Receptacle strip, double row, .079" (2.00mm) pitch, top entry